

DRINKS | Drink Cabinets

DRINK COOLER ► UPRIGHT COOLERS

RCF 145

CUSTOMIZATION AVAILABLE
PERSONALIZZAZIONE DISPONIBILE

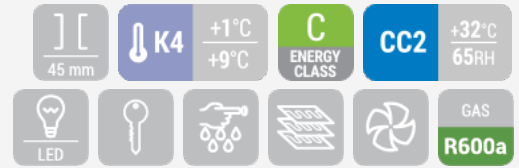

DETAILS

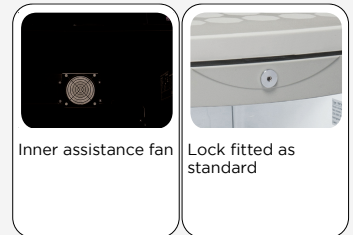

GENERAL FEATURES

115 Lt. Upright drink cooler	•
External in white coated plate, white thermoformed internally	•
Roll-bond evaporator system with fan assisted cooling	•
Manual Defrost	•
Foaming Agent Cyclopentane (45mm per side)	•
Removable Gasket	•
Independent switch for internal light	•
Double layer safety tempered glass (Curved)	•
Digital thermometer	•
Reversible door	•
Lock fitted as standard	•
Adjustable shelves (White Color): 3 Pcs	•
N.4 Adjustable feet	•
Energy efficiency class: C	•

TECHNICAL SPECIFICATIONS

Capacity	115 L
Temperature	K4 (+1°C-+9°C)
Consumption	2.76 kWh/24h
Rated Power	90 W
Noise level	47 dB(A)
Net Weight	37 Kg
Gross Weight	40 Kg
External Dimensions (WxDxH mm)	505x590x855
Internal Dimensions (WxDxH mm)	410x395x700
Packaging dimensions (WxDxH mm)	580x620x880
Loading quantities 20'/40'/40"HQ	72/158/220

CERTIFICATION

CE RoHS

PRODUCT DIMENSIONS

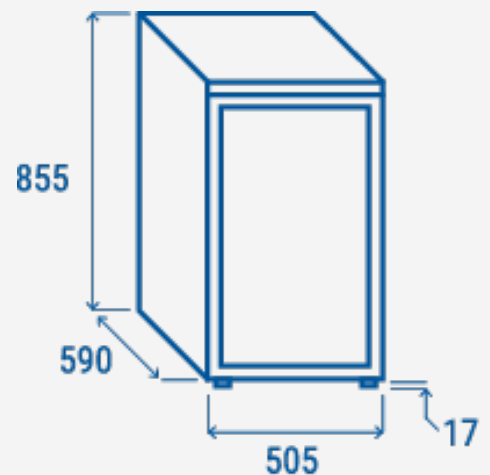

RIGHTWAY ASIA
We make the world a cooler place